

HELLO MAN

INCLUDED



x 1

built-in fan

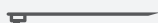

x 4

straight pin with eyelet



x 1

mounting hammer

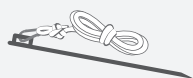

x 4

straight pin with eyelet and extraction ropes



x 1

spare hand



x 1

built-in cover

ASSEMBLY INSTRUCTIONS



On the Hello Man and Windy Man models, the fan draws air in from underneath. Only place the product on a hardened and level surface to avoid damage to the product.

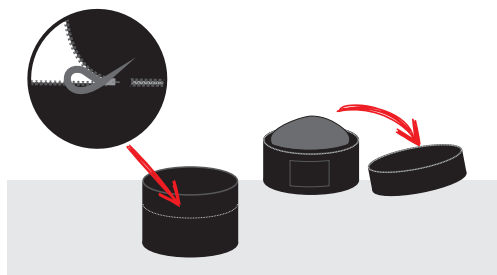

1

On the Hello Man and Windy Man models, the fan draws air in from underneath. Only place the product on a hardened and level surface to avoid damage to the product.

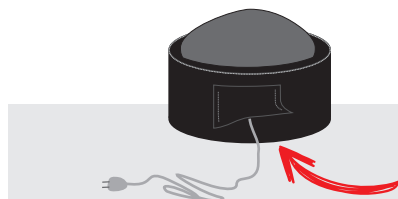

2

Unfasten the Velcro-fastened flap at the base of and remove the Hello Mana power cable.

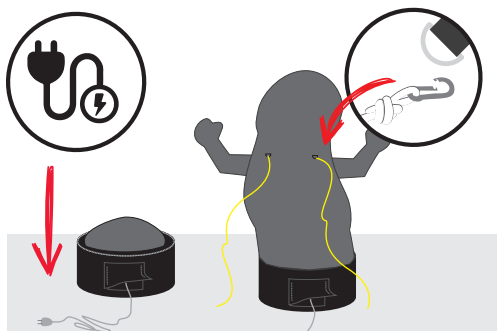

3

Plug the power cable into the power supply and wait for Hello Man to take shape. Attach the cables to the lashing eyes using the snap hooks.

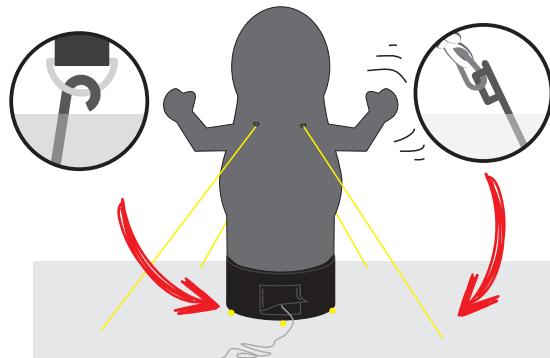

4

Stabilise the Hello Man by hammering pins into the ground for the lashings at its base and for the lashing lines. The lashing lines should be taut and stretched to their full length.

!

For substrates that do not allow the use of pins, a dedicated weight plate should be used in the Hello Man base.

HAND MOVEMENT ADJUSTMENT



The hand in motion, waving.

To get Hello Man actively swinging his arm, open the zipper of the forearm lock to achieve the desired waving effect.



The hand without moving

To keep Hello Man's hand stationary, zip up Hello Man's hand.

EXCHANGE OF WAVING HAND



Lay the Hello Mana cover flat on a clean and dry surface. Unzip the zip on the movable arm and replace the sleeve by zipping it up.

HELLO MAN

INCLUDED



x 1

built-in fan

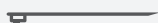

x 4

straight pin with eyelet



x 1

mounting hammer

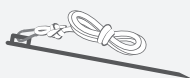

x 4

straight pin with eyelet and extraction ropes



x 1

spare hand



x 1

built-in cover

DISASSEMBLY INSTRUCTIONS

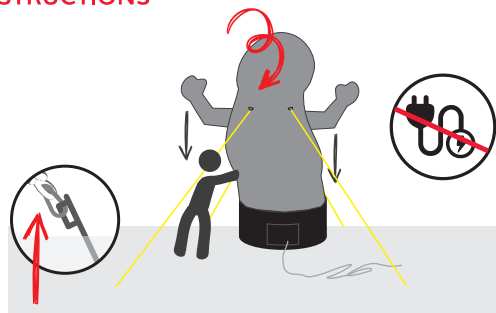

- 1 Zdemontuj szpilki z linek i odłącz kabel zasilający. Przytrzymaj poszycie aby nie uległo zabrudzeniu, jednocześnie zawijając go od góry do środka pokrowca.

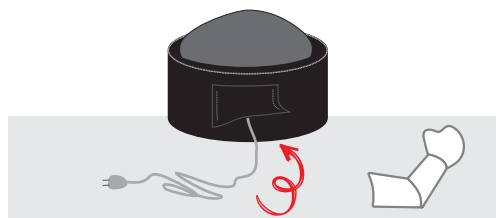

- 3 Zwiń i schowaj kabel zasilający do wnętrza pokrowca. Pamiętaj o zapasowej ręce!

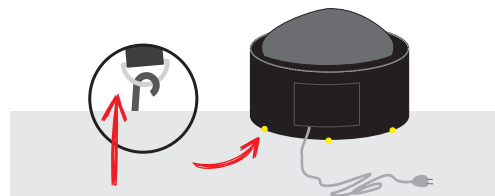

- 2 Zdemontuj szpilki z podstawy Hello Mana i zapakuj do torby.

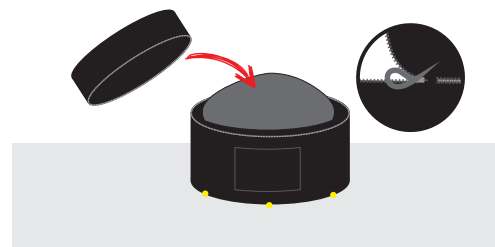

- 4 Na koniec zapnij górny pokrowiec torby na zamek.

INSTRUCTIONS OF USE

1. Please read the product assembly/disassembly instructions before assembly.
2. When transporting, setting up and assembling the product, take special care to avoid damage to the product or injury during assembly.
3. Before disassembling the product, ensure that there are no sharp objects, tools, etc. with sharp edges in the area where the product will be assembled.
4. Check the condition of the electrical cables before connecting to avoid electric shock.
5. Do not obstruct the fan. The product should be positioned so that the ventilation hole has free access to air.
6. To avoid tripping hazards, the extraction cords should be positioned outside the passageways. If the lashings have to cross passageways or are close to passageways, they must be clearly marked (e.g. with warning tape).
7. During increasing gusts of wind, the seating of the pins/anchors must be checked systematically. In winds above 38km/h, the product must be assembled immediately.
8. During rain or snowfall, excess water/snow should be systematically removed from the product.
9. Any soiling must be removed immediately with a damp cloth and warm water without using detergents. The use of high-pressure cleaners is prohibited.
10. The product should be cleaned and dry before disassembly. If, due to weather or other circumstances, the product is assembled wet and dirty, it should be disassembled again as soon as possible, dried and cleaned.
11. The product should be stored in a dry and clean place.



recommended minimum distance from product: 2m



risk of ignition following contact with a fire or ignition source



risk of entanglement or tripping over lashing ropes



risk of overturning due to incorrect installation or strong winds



inappropriate use e.g. climbing



prohibition of use in case of damage to the power cable