

SCREEN WITH VENTILATOR

INCLUDED



x 1

built-in fan



x 4/8*

extraction lines



x 6/10*

anchors



x 1

assembly hammer



x 1

transport bag

ASSEMBLY INSTRUCTIONS

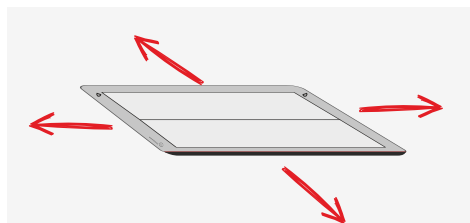

- 1 Spread the screen on a flat and dry surface with the fan on top. If possible, use a sheet so as not to soil the cover.

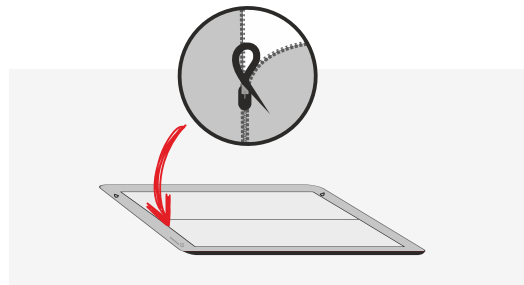

- 2 Fasten the lock located on the side of the screen base, next to the fan.

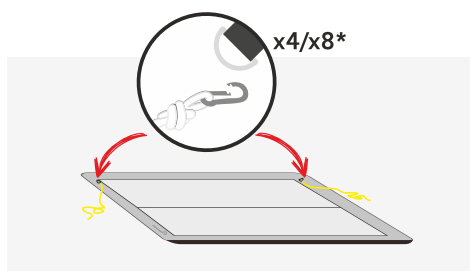

- 3 Attach the cables to the lashing eyes in the screen using snap hooks.

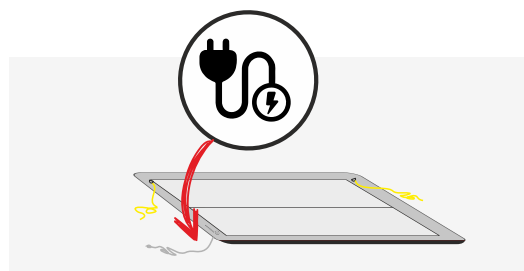

- 4 Plug in the fan supply cable from the screen and wait until it fills with air. Remember not to obstruct the fan inlet!

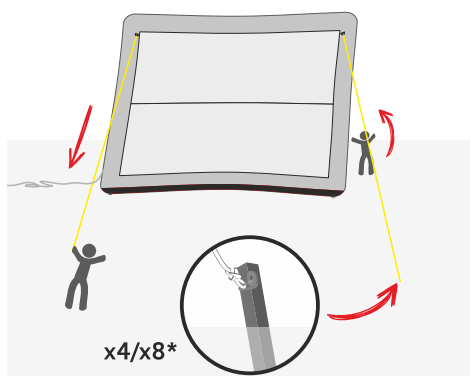

- 5 Stand the screen up using cables and fix each cable to the ground with anchors using a hammer. The lines should be taut and stretched to their full length.

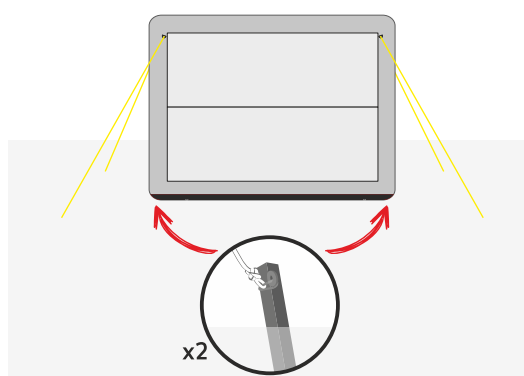

- 6 Stabilise the screen with lashings in the base. Fix them to the ground with anchors using a hammer.

! For substrates that do not allow the use of pins/anchors, dedicated weights or weight bags should be used for the cables and bottom lashings at the base.

*w zależności od rozmiaru ekranu.

SCREEN WITH VENTILATOR

INCLUDED



x 1

built-in fan



x 4/8*

extraction lines



x 6/10*

anchors



x 1

assembly hammer



x 1

transport bag

DISASSEMBLY INSTRUCTIONS

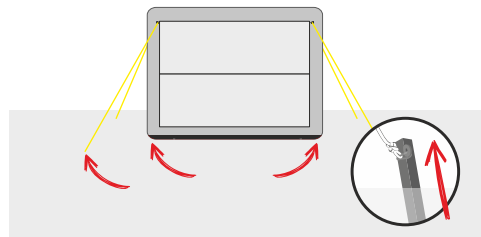

- 1 Remove all anchors from the ground (from the lashing lines and lashings in the base).

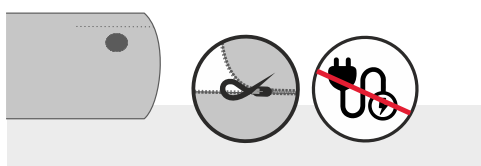

- 3 Unplug the product and undo the zipper on the side next to the fan. This will start to let the air out of the product.

- 5 Assemble and pack the mounting kit in the accessory bag.

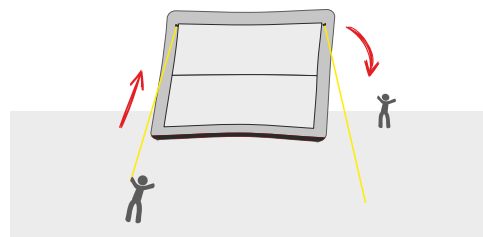

- 2 Slowly lay the screen on a flat and dry surface using the ropes. If possible, use a protective sheet.

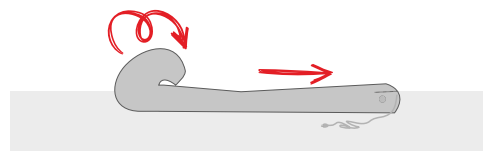

- 4 Unfasten all cables attached with snap hooks to the lashings in the screen. Fold the screen in half with the fan on top and start to slowly roll the product towards the fan.

- 6 Pack the product and accessory bag into a dedicated carry bag.

INSTRUCTION OF USE

1. Please read the product assembly/disassembly instructions before assembly.
2. When transporting, setting up and assembling the product, take special care to avoid damage to the product or injury during assembly.
3. Before disassembling the product, ensure that there are no sharp objects, tools, etc. with sharp edges in the area where the product will be assembled.
4. Check the condition of the electrical cables before connecting to avoid electric shock.
5. Do not obstruct the fan. The product should be positioned so that the ventilation hole has free access to air.
6. To avoid tripping hazards, the extraction cords should be positioned outside the passageways. If the lashings have to cross passageways or are close to passageways, they must be clearly marked (e.g. with warning tape).
7. During increasing gusts of wind, the seating of the pins/anchors must be checked systematically. In winds above 38km/h, the product must be assembled immediately.
8. During rain or snowfall, excess water/snow should be systematically removed from the product.
9. Any soiling must be removed immediately with a damp cloth and warm water without using detergents. The use of high-pressure cleaners is prohibited.
10. The product should be cleaned and dry before disassembly. If, due to weather or other circumstances, the product is assembled wet and dirty, it should be disassembled again as soon as possible, dried and cleaned.
11. The product should be stored in a dry and clean place.



risk of ignition following contact with a fire or ignition source



risk of entanglement or tripping over lashing ropes



risk of overturning due to incorrect installation or strong winds



inappropriate use e.g., climbing



risk of damage to the power cable, e.g., on an electric pump

*w zależności od rozmiaru ekranu.